





The Battery Pack is the Heart of your Rig. Choose Wisely...

Who We Are

In this technology driven industry, where cameras come and go; acquisition, content and delivery give way to the next growth segment, and we strive to be at the forefront.

This passion has made Hypercore the top battery packs in the industry. Used by companies from ARRI to RED Digital. The Top wildlife documentarians capturing awe inspiring footage of nature's most beautiful imagery rely on Hypercore. And used by our very important passionate client base, capturing their life's work, from extreme sports to indies. Core SWX powers the industry.

We wanted a brand which speaks to our mission; what we are about, what's in our core.

We have the passion to power the industry and a mission to allow filmmakers to focus on production to inspire.

At Core SWX we are *Providing The Power To Create™*.



What We Do

Core SWX is the Market leader in batteries and charging solutions for the broadcast, digital cinema and the professional video industries, along with emerging markets such as drones and virtual reality.

Our flagship products, including the Hypercore line of batteries, remain at the forefront, providing you the power to create in a variety of applications. Compatible with the leading professional and consumer manufacturers, such as Sony, Panasonic, Canon, RED, Blackmagic Design and more, Core SWX stays ahead of the curve in technology-driven are that is constantly evolving.

With the release of our Core Helix line of battery packs, quite possibly the most complete battery product ever offered to the industry, we are setting new trends, breaking old conceptions, and continuing our commitment in offering cutting-edge technology to the mobile power segment.

Contents

HELIX BATTERY PACKS	1-2
HELIX PLATES / ACCESSORIES	3-4
NEO 9MINI	5-6
NEO SLIM98	7-8
NEO150 / HC150 / PRIME	9-10
XL / NANO M-SERIES / NANO V98	11-12
EDGE / EVO	13-14





NPF-SHD / FLEET-Q4FF / QUANTUM	15-16
VOTBRIDGE / MICRO CHARGER	17-18
FLEET CHARGERS	19-20
X2 / X2MINI / BATTERY MOUNT ACCESSORIES	21-22
POWERBASE/ NP BATTERIES / CUBE	23-24
LIGHTING / HOTSWAP PLATES	25-26
HDV / DV / ACCESSORIES / CABLES	27-28



DUAL VOLTAGE BATTERY PACKS

Simultaneous 14v/28v Power Output

Helix is the most complete on-board battery system ever offered to the cinematic industry. The system encompasses all the features of Hypercore, with the added function of dual 14v/28v* simultaneous voltage output, answering the call for better designed and performing, on-board high voltage solutions.

Near Lossless Power Transmission

Leveraging a proprietary, patent pending technology, Helix is ultra efficient, providing nearly lossless power transmission at a 99% efficiency rate to high voltage operating equipment. Helix's unique design allows it to output up to 33.6v, within the top range of high voltage acceptance, thus drawing less current, creating less heat and extending both operational runtime and product longevity.

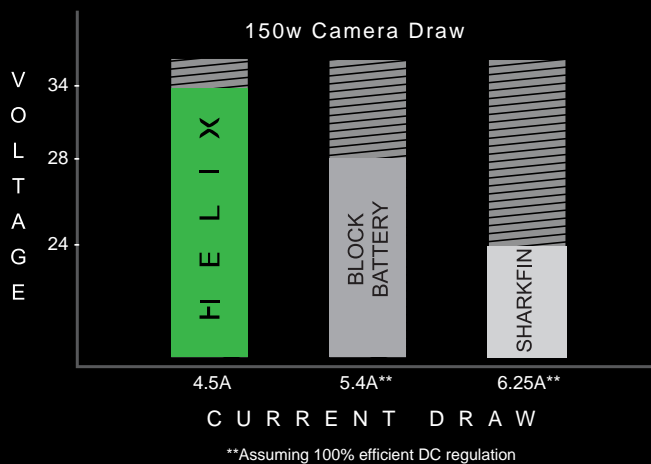

Ultra Compatible V-mount & Gold mount

Helix's uniquely designed infrastructure allows the pack to function as a standard V-mount or Gold mount 14v pack in all applications without the fear of accidentally transmitting high voltage. Along with standard powering applications, Helix charges on all standard v-mount and gold mount Lithium-Ion equipment, including Anton/Bauer, allowing it to seamlessly integrate into your current fleet of battery packs.

*The mean voltage rating of Helix's outputs are 14v and 28v, with a maximum charge rating of 16.8v and 33.6v. Most high voltage range equipment accepts up to 34v.

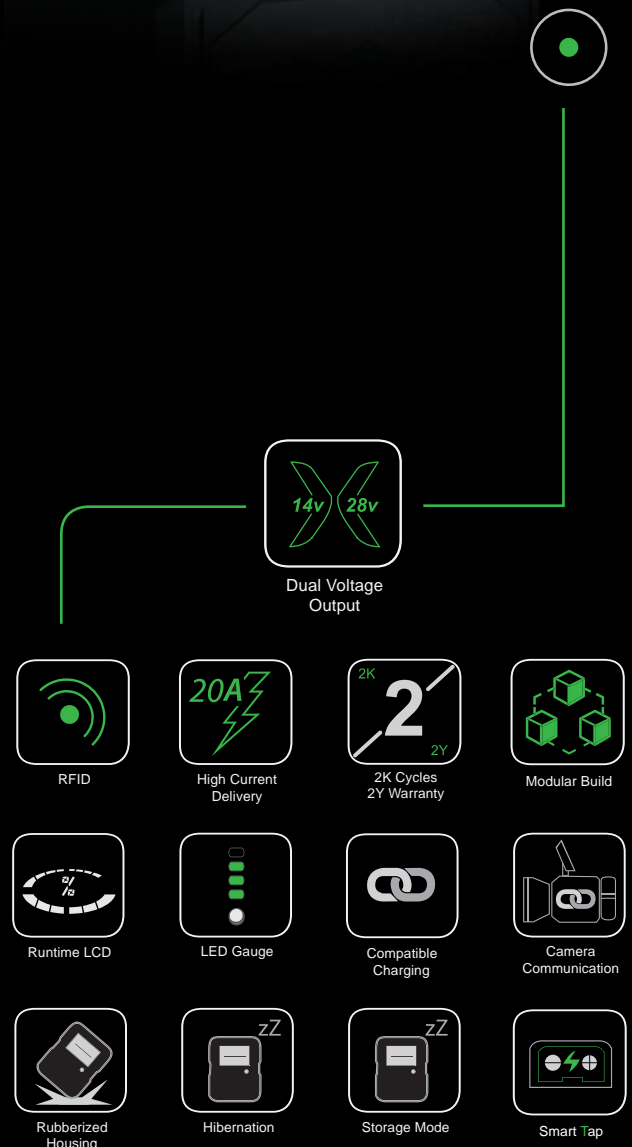



Core has produced a series of mount plate offerings for high voltage accepting equipment. To unlock the high voltage output function, couple HELIX with the mount plate. Once mounted, the battery pack will transmit the higher voltage efficiently to the camera, yet still have access to 14v for other production accessories. In addition, the battery mount plates are compatible with standard on-board battery packs. This compatibility allows you to still use your existing V-mount and Gold mount battery packs on wide rang voltage cameras(ARRI Alexa, Amira, Mini Alexa, etc.) when using a Helix mount.

The Helix system is provided in V-mount and Gold mount, with the familiar offerings of a Mini9(98wh), a Prime(2-part 190wh), and an XL 293wh model. In addition to these models, a Mini 150wh model is now available to answer the need for a cinematic, small form option, providing longer runtimes to that of the Mini9.



H E L I X



HLX 9S
V-mount SMBUS

98wh
14.8v native/6.6Ah
3.54" x 4.65" x 1.90"
1.4lbs
Max Load:6A @ 33.6v



HLX 150S
V-mount SMBUS

147wh
14.8v native/ 9.9Ah
3.54" x 4.65" x 2.38"
1.8lbs
Max Load: 6A @ 33.6v



HLX PRIMES
V-mount SMBUS

190wh
14.8v native/ 2-part 12.8Ah
3.8" x 6.6" x 2.4"
2.6lbs
Max Load: 6A @ 33.6v



HLX XLS
V-mount SMBUS

293wh
14.8v native/ 19.8Ah
3.8" x 5.87" x 2.95"
3.4lbs
Max Load: 7.5A @ 33.6v



HLX 9AG
3-Stud A/B Compatible

98wh
14.8v native/6.6Ah
3.54" x 4.65" x 1.90"
1.4lbs
Max Load:6A @ 33.6v



HLX 150AG
3-Stud A/B Compatible

147wh
14.8v native/ 9.9Ah
3.54" x 4.65" x 2.38"
1.8lbs
Max Load: 6A @ 33.6v



HLX PRIMEAG
3-Stud A/B Compatible

190wh
14.8v native/ 2-part 12.8Ah
3.8" x 6.6" x 2.4"
2.6lbs
Max Load: 6A @ 33.6v



HLX XLAG
3-Stud A/B Compatible

293wh
14.8v native/ 19.8Ah
3.8" x 5.87" x 2.95"
3.4lbs
Max Load: 7.5A @ 33.6v

HLX On-Board Plates



Direct Mount for ARRI

V-MOUNT: HLX-BAB-V
3-STUD: HLX-BAB-G

Mounts directly to ARRI LF and Alexa to provide a direct connection to the camera. When coupled with HELIX packs outputs up to 33.6vdc. Also accepts standard 14v packs.

Input: DC 11-34v

Output for Camera: DC 11-34v

Output for P-taps: DC 11-16.8v



Sony Venice

V-MOUNT: HLX-VEN-V
3-STUD: HLX-VEN-A

The HLX-VEN-V mounts to the Sony Venice with v-mount back with and without the RS7 module, and has a v-mount front. RS loops through port for start/stop. It passes standard 11-17vdc to camera. With HELIX packs, 100% efficient power is transmitted to 3pin Fischers. With 14v packs, the mount plate boosts voltage to 24v to 3pin Fischers connectors.

Input: DC 11-17v

Output for Camera/P-Taps:
11-16.8V

3p Fischer DC 24-34v



HLX Plate w/ Clamp & XLR

V-MOUNT: HLX-SCPM
3-STUD: HLX-ACPM

Helix V-Mount & 3-Stub Plate with Light Stand Clamp and 24" 3 Pin XLR

Input: DC 11-34v

Output for P-Tap:
11-16.8V

Output for XLR:
22-33.6vdc *requires
Helix battery pack

HLX Hot Swap



Hotswap/Sharkfin

V-MOUNT: HLX-TS-SFF
3-STUD: HLX-TA-SFF

Accepts HELIX packs and standard 14v packs. When 2 HELIX packs are on-board and connected to a HLX mount plate, the adapter can output both 11-17vdc and 22-34vdc. A separate pin set for high voltage allows for safe power transmission. Accepts standard 14v packs.

Output for Camera without Helix ARRI plate: DC 11-17v

Output for Camera with Helix ARRI plate: DC 22-34v

Output for P-taps: DC 11-16.8v



COREN98S/AG (NANO Slim)

Capacity: 98wh (14.8V, 6.6 Ah)

Size: 3.8 x 5.87" x 1.49"

Weight: 1.4 lbs.

Normal Runtime: (25W) 3.6Hrs

Max Load: 8A



CORE-N98S
V-mount



CORE-N98AG
3-Stud mount
A/B Compatible



Camera
Communication



USB
Power



LED
Gauge



Compatible
Charging



Rubberized
Housing



Travel
Safe



Smart
Tap

NANO XL

178Wh (14.8V, 12 Ah)

3.8 x 5.87" x 2.44"

2.4 lbs.

Normal Runtime: (25W): 7.1Hrs

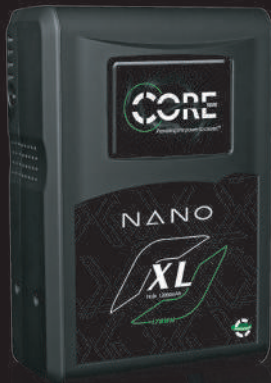

NANOXLV
V-mount
Standard SMBUS

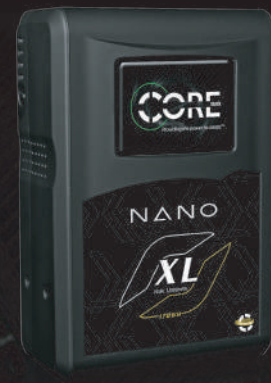

NANOXLAG
3-Stud mount
A/B Compatible



Camera
Communication



USB
Power



LED
Gauge



Compatible
Charging



Rubberized
Housing



Smart
Tap

NEO



Rated for 2K Cycles with a 2 Year warranty.

2K Cycles
2Y Warranty



Neo 16 Amp Peak with 12 Amp draw.

High Current Delivery



Through USB Neo packs are now firmware upgradeable.

Firmware Upgradeable



All Hypercore Packs have a Modular Build design. The design reduces wiring and insures the maximum build integrity.

Modular Build



Able to communicate to cameras as well as chargers with both one-wire, and two-wire protocols.

Camera Communication



UN38.3 certified & travel safe battery pack to make customers traveling experience go as smooth as possible.

UN38.3 Certified



The packs go to sleep/hibernate when there is no battery usage or movement after a 48 hour period. Once the battery is picked up, the battery pack awakens.

Hibernation



New backlit LCD is multipurpose. It provides nominal runtime based off of 25w load, remaining runtime once connected to a device, and remaining charge time when on a charger.

Runtime LCD



With the display on the side of all brick battery packs, a user can easily glance at remaining battery capacity.

LED Gauge



Our packs are the most charger compatible in the industry which allows users with existing charger hardware to continue using their charger.

Compatible Charging



The packs are incased in an over-molded, non-slip rubberized housing to help provide cell protection against accidental impacts.

Rubberized Housing



To protect self-discharge and help comply with travel regulations, Core SWX incorporated storage mode into all brick battery packs.

Storage Mode



Integrated "Smart" p-tap connector to allow users to power any 12vdc device while also receiving all battery data from the port.

Smart Tap



NEO battery packs offer a 5v USB port for any accessory on set that may use USB or to even charge mobile devices.

USB Power



View your battery vitals from mobile app or RFID reader.

RFID



NEO-9 MINI

Cinematic Small Form Factor



Compact, robust and lightweight.
Sustains up to 16A peak loads, and 12A continuous.
USB firmware programmable. More intuitive LCD.
All the features of Hypercore.

Simply, the perfect 14v pack.



NEO-9S
V-mount
Standard SMBUS*

98wh (14.8V, 6.6 Ah)
3.54" x 4.65" x 1.90"
1.4 lbs.



NEO-9AG
3-Stud mount
A/B Compatible

Available in V-mount and 3-stud. The NEO-9S communicates standard SMBUS for the majority of V-Mount cameras/applications, and RED DSMC2. The 3-stud NEO-9AG model is Anton/Bauer charge compatible and communicates with all 3-stud production equipment utilizing single-line digital communication.

*Reverse SMBUS programmable for RED DSMC.

HYPERCORE
NEO
SLIM



NEO-98 Slim

Slim Form Factor



A 98wh workhorse.
3/4" thinner than the competition
On-board monitors, broadcast cameras, endless applications.
16A peak load handling. 12A continuous

Slim. Powerful. Intelligent.



NEO-S98S
V-mount
Standard SMBUS

98wh (14.8V, 6.6Ah)
3.8" x 5.87" x 1.49"
1.4lbs.



NEO-S98AG
3-Stud mount
A/B Compatible

Available in V-mount and 3-stud. The NEO-S98S communicates standard SMBUS for the majority of V-Mount cameras/applications, and RED DSMC2. The 3-stud NEO-S98AG model is Anton/Bauer charge compatible and communicates with all 3-stud production equipment utilizing single-line digital communication.

NEO-150

Cinematic Small Form Factor



A rugged 147wh Mini.
Sustains up to 16A peak loads.
The highest energy deliverable pack in it's class.
50% longer runtime than a 98wh pack.
RFID enabled.



NEO-150S
V-mount
Standard SMBUS*

The Everyday Trailblazer

147wh(14.8v, 9.9Ah)
3.54" x 4.65" x 2.38"
1.8lbs.



NEO-150AG
3-Stud mount
A/B Compatible

Available in V-mount and 3-stud. The NEO-150S communicates standard SMBUS for the majority of V-Mount cameras/applications, and RED DSMC2. The 3-stud NEO-150AG model is Anton/Bauer charge compatible and communicates with all 3-stud production equipment utilizing single-line digital communication.

*Reverse SMBUS programmable for RED DSMC.

HYPERCORE 150

150Wh (14.8V, 10.3 Ah)

3.8 x 5.87" x 2.63"

2.4 lbs.

Normal Runtime: (25W): 6Hrs



Hypercore-150S
V-mount



Hypercore-150AG
3-Stud mount
A/B Compatible



USB Power



Runtime LCD



LED Gauge



Compatible Charging



Camera Communication



Smart Tap



Hibernation



Storage Mode

Hypercore PRIME

TWO PART SPLIT BATTERY PACK

14.8v, 190wh/13.5Ah

2.6lbs

3.8" x 6.6" x 2.4"

Each half: 95wh (14.8V, 6.7Ah)



HCPrimeS
V-mount
Standard SMBUS



HCPrimeAG
3-Stud mount
A/B Compatible



Runtime LCD



Camera Communication



USB Power



LED Gauge



Compatible Charging



Rubberized Housing



Travel Safe



Smart Tap



Any charger within Core SWX' charger lineup will charge Hypercore, but the battery series is also the most cross platform, charger-compatible in the industry today. The V-mount offerings (Hypercore S) will also charge on IDX™, Sony™, and RED™, allowing you to maximize service life out of your current charger.

Hypercore XL

Cinematic High Output Battery Pack

293wh (14.8V, 19800 mAh)

3.4 lbs.

3.8" x 5.87" x 2.95"



HCXL-V
V-mount
Standard SMBUS



HCXL-AG
3-Stub mount
A/B Compatible



USB Power



Runtime LCD



LED Gauge



Compatible Charging



Camera Communication



Rubberized Housing



Hibernation



Storage Mode



Smart Tap

Nano M-Series BATTERY PACKS

The Nano-M series addresses the need for a more “pro” style option of power for Small Form Cine cameras. They are equipped with a 4-stage LED gauge and a P-tap. The P-Tap is a Smart Tap that is able to carry SMBUS/smart battery data which is a feature part of future integration. This power tap will serve as a standard powertap without the need



NANO-C98

Capacity: 98wh (14.8v, 6600mah)

Size: 3.85" x 2.6" x 1.65"

Weight: 0.9lbs

Normal Runtime: 4hrs without accessories

These packs charge on OEM Canon chargers.



NANO-VBR98

Capacity: 98wh (7.4v, 13200mah)

Powertap Output: 12vdc (2A/24watt max)

Size: 4" x 2.6" x 1.65"

Weight: 0.9lbs

Normal Runtime: 5hrs. based off of Panasonic EVA1 draw

These packs charge on OEM Panasonic chargers.



NANO-U98

Capacity: 98wh (14.8v, 6600mah)

Size: 3.85" x 2.6" x 1.65"

Weight: 0.9lbs

Normal Runtime: 8hrs. based off of Sony FS5 draw

These packs charge on OEM Sony chargers.



USB Power

NANO-U98 & C98 only



LED Gauge



Compatible Charging



Camera Communication

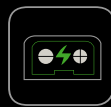

Smart Tap



Travel Safe

NANO 98

MICRO Battery Pack



Quite possibly the smallest V-mount and 3-Stub mount style pack on the market today. Measuring in at less than 4" in height and 2" in depth, while weighing a feathery 1.2lbs., Now capable of handing up to 12A, consider these packs for lighter camera powering applications, on-board monitors, recorders, wireless tx/rx, etc.



NANO-V98
V-mount
Standard SMBUS*

The perfect "grab and go" pack for the majority of powering applications.

98Wh(14.8v, 6.6Ah)
3.93" x 2.82" x 1.94"
(100mm x 71mm x 48mm)
1.2lbs.



NANO-G98
3-Stub mount
A/B Compatible

The 14.8v, 98wh capacity allows for the packs to be transported carry-on without restrictions under IATA, ICAO and UN regulations. The packs have been UN tested and certified, passing UN38.3 certification.

MOUNTS



CXV-KOMU

BP to V-mount plate direct mount for RED® KOMODO™

The CXV-KOMU is a BP to V mount plate direct mount specifically designed for the RED® KOMODO™ camera, allowing use of 14.4V 3-stud batteries and leaving the camera's DC input available for AC power and battery hot swap.



CXA-KOMU

BP to 3-stud plate direct mount for RED® KOMODO™

The CXA-KOMU is a BP to 3 Stud plate direct mount specifically designed for the RED® KOMODO™ camera, allowing use of 14.4V 3-stud batteries and leaving the camera's DC input available for AC power and battery hot swap.



CXVM-FX6

A v-mount micro-style power option for the Sony FX6

The CXVM-FX6 mounts directly to the back of the Sony PXW-FX6.



CXVA-FX6

A 3 Stud micro-style power option for the Sony FX6

The CXVA-FX6 mounts directly to the back of the Sony PXW-FX6.



CXV-C3MK2

Mini V-Mnt Plate for Canon EOS Cameras

V-Mount Battery Plate for Canon EOS Cine Cameras with 4-Pin XLR Input

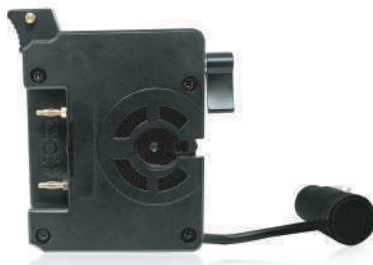

CXA-C3MK2

Mini 3 Stud Plate for Canon EOS Cameras

3 Stud Mount Battery Plate for Canon EOS Cine Cameras with 4-Pin XLR Input



GP-TAMICRO

Micro 3-Stud Hotswap Adapter

The GP-TAMICRO is a micro form factor Hotswap Shark-fin adapter that mounts directly to the existing 3-stud plate on the camera.

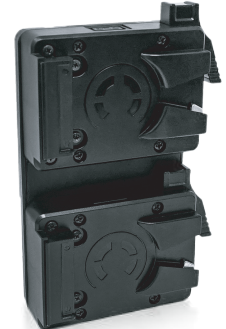

GP-TSMICRO

Micro V-mount Hotswap Adapter

The GP-TSMICRO is a micro form factor Hotswap Shark-fin adapter that mounts directly to the existing 3-stud plate on the camera.

Powerbase EDGE

Most Versatile Battery Pack

The follow-up to the highly successful Powerbase70, the Powerbase Edge is a feature-rich “small-form” Cine and DSLR pack, in a v-mount form. The 14.8v Lithium Ion pack includes one 8v port to power various cameras, two USB output, and two power tap outputs, one of which being a SmartTap.

The 8v port provides a common power output for the majority of DSLRs and small-form cine cameras on the market which utilize small 7.4v Li-Ion battery packs. There are an assortment of dummy battery cable attachments available which insert into that 8v port. In addition to powering the camera, two on-board powertaps are accessible to power monitors, lights, wireless transmitters, etc. The two available USB ports are a welcoming addition to power/charge mobile devices on the fly, as well as power any 5v accessories (i.e. select audio recorders).

As it is often difficult to approximate runtime when powering the camera as well as multiple devices, the Powerbase Edge has a built-in runtime LCD, to deliver exact battery expectancy to the minute. The LCD also has a button activated backlight to be view-able in any environment. As with it's predecessor, the Edge has a quick release plate to attach underneath the camera, or quickly attach/detach to a rig or camera cage. It is 30% smaller than the Powerbase 70 yet can still withstand the draw of a full size Cinematic cameras.



PB-EDGE

49wh(14.8vdc, 3.3Ah)
 Size: 5.1" x 3.6" x 1.55"
 Weight: 1.3lbs.
 Normal Runtime: approx. 8.25 hours (Sony A7 w/o accessories)
 Max Continuous Load: 8A

DSLR MODELS #s:

- | | |
|--------------|----------------|
| PBE-LPE6 | Canon LP-E6 |
| PBE-GH | Lumix GH4/5/5s |
| PBE-A7/ A7FZ | Sony A7/A9* |
- *contact your reseller for compatible model

CAMCORDER MODELS #s:

- | | |
|---------------|-----------------|
| PBE-VBR | Panasonic VBG |
| PBE-S | Sony L Series |
| PBE-C100/C300 | Canon C100/C300 |
| PBE-BMPC4 | BMD Pocket 4K |
| PBE-BMPC6kp | BMD Pocket 6K |



USB Power



Runtime LCD



LED Gauge



Compatible Charging



Camera Communication



Smart Tap



Hibernation



Storage Mode



Travel Safe

NPF-SHD

Designed for the SmallHD Focus

7.4v 7800mah

dims: 5.2" x3.1" x 1.3"*

Weight: 0.78lbs

*includes battery sled

The NPF-SD is a near 60wh L-series type lithium ion battery pack design to provide a lower profile powering solution for the SmallHD Focus monitors.

It was designed to allow for full rotation of the monitor on the tilt arm while not blocking the air vents on the back of the monitor.

The battery pack features a 4-stage LED gauge along with a 7-17v DC input which allows you to powertap into the battery pack on larger camera rig configurations and route regulated power into the monitor. Should the DC input power be interrupted, the pack will seamlessly being discharge from the battery cells. While the DC input allow for the added flexibility of charging the pack, the pack will charge from most L-series chargers as well.

#NPF-SHD



FLEET-Q4FF

Designed for Movi Pro battery packs

Quick Charge Current: 2.5A

Size: 10.9" x 4.9" x 3.26"

Weight: 2.1lbs.

Input Voltage: 90-240VAC

50/60Hz

The Core SWX Fleet FF charger is a four position, simultaneous charger specifically designed for Movi Pro battery packs by FreeFly Systems. The charger provides the ability to charge 4 of the battery packs in approximately 45 min, giving you plenty of time to use and rotate your battery packs.

As with all Fleet chargers, the Fleet FF charger's bays act independently, allowing each bay to focus on the individual battery connected. The charger's low profile and compact design takes up as little space as possible, measuring in at 10.9" x 4.9" x 3.26" (277mm x 125mm x 83mm).

#FLEET-Q4FF



FLEET QUANTUM



FLEET QUANTUM

The new FLEET Quantum series are the next generation of smart chargers. The chargers offer a highly efficient "2x2" simultaneous charge. When four packs are placed on the charger, the charger detects which two packs have the most charge capacity, and first charges those to full capacity. With a 4A/hr charge protocol, the charger can charge four 98wh packs in 3hrs, utilizing half the power of previous generation chargers.

With a large color touchscreen LCD with graphical user interface, the charger provides the utmost transparency on stored smart battery data including state of charge, cycle count, capacity data, etc. The charger also provides a battery health analysis to alert the user of any abnormalities which may require a cell balance.



Color Touchscreen GUI



Fleet Rapid Charge



Battery Health Analysis



Compatible Charging



Energy Efficient

FLEET-Q4US V-mount



Quick Charge Current:
4A 2x2 Simultaneous

Size: 9.1" x 3.35" x 12.17"

Weight: 5lbs.

Input Voltage:
90-240VAC 50/60Hz

LCD: Color touchscreen

FLEET-Q4UA 3-Stud mount A/B Compatible



VOLTBRIDGE

WIRELESS CHARGER MANAGEMENT

Core's patented Voltbridge Fleet battery management platform is a system of autonomous battery chargers controlled by a mobile application, available for iOS and Android, allowing a single user to oversee tens of professional video battery chargers and hundreds of battery packs. The mission of the platform is to streamline the process of determining what V-mount and Gold mount packs are viable, and which should be inspected more closely. As battery power is the most critical part of any mobile/field production, large production/broadcast houses, as well as Professional Video and Cinema Rental companies will be able to administer over a single or many mobile devices (ie. iPad, Android Tablet).

Considering Lithium-Ion battery packs are the most prevalent used in production, and their is well documented, inherent risks with the chemistry, this battery management system will help reduce the risk of potential Li-Ion battery related issues, by allowing the user to quickly determine and designate the packs which may be of concern.

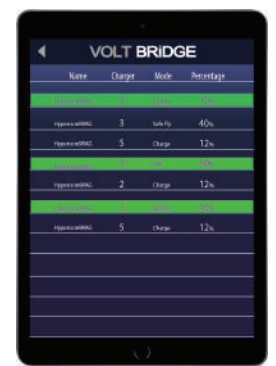

By being able sort through hundreds of connected battery packs' smart data vitals, the user can determine the packs with diminished service life quickly, providing an opportunity to test and evaluate the packs through the system. Currently this can be done, but requires a service tech to review each charger's display manually, and even in the most sophisticated charging systems, the LCD would only display the data of up to four battery packs at one time.

By more quickly determining an issue, you may be able to restore battery capacity through Core SWX's proprietary cell balancing algorithm, maximizing ROI and service life of the pack, as well as preventing a potential battery related issue later on. The system also allows to remotely initiate Core SWX's SafeFly mode, which discharges the packs to under 30% charge capacity, the current Lithium Ion threshold for safe transport according to the FAA and IATA.



FLEET MICRO Q

FLEET Qi

The Fleet Micro Q and Fleet Q "i" series of chargers continue to be the most advanced in the industry, now with the inclusion of the Voltbridge Wireless Charger Fleet management. The chargers offer a complete battery management system for your battery "Fleet."



SafeFly Mode



Battery Management Test Mode



Fleet Rapid Charge



Multifunction LCD



Power Supply Mode



Compatible Charging

FLEET-Q4MSi

V-mount



Quick Charge Current:
3A Simultaneous

Discharge Current:
Up to 2A per channel

Size: 9.1" x 3.35" x 12.17"

Weight: 5lbs.

Input Voltage:
90-240VAC 50/60Hz

LCD: 4x20 Character Backlit

FLEET-Q4MAi

3-Stud mount
A/B Compatible



FLEET-Q4Si

V-mount



Quick Charge Current:
3A Simultaneous

Discharge Current:
Up to 2A per channel

Size: 9.1" x 3.35" x 12.17"

Weight: 5lbs.

Input Voltage:
90-240VAC 50/60Hz

FLEET-Q4Ai

3-Stud mount
A/B Compatible



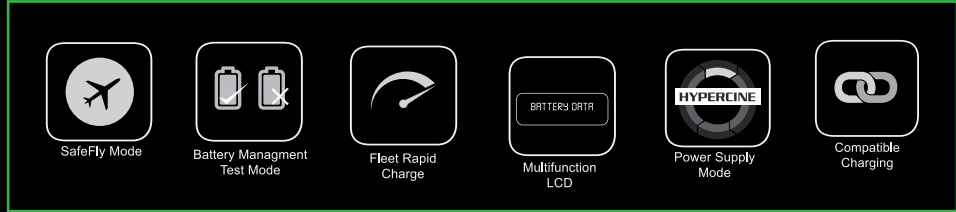

The Fleet Q4 “i” series of chargers continue to be the most advanced in the industry, now with the inclusion of the Voltbridge Wireless Charger Fleet management. The chargers offer a complete battery management system for your battery “Fleet.”

FLEET-Q4Si
V-mount



Quick Charge Current:
3A Simultaneous

Discharge Current:
Up to 2A per channel

Size: 9.1” x 3.35” x 12.17”

Weight: 5lbs.

Input Voltage:
90-240VAC 50/60Hz

FLEET-Q4Ai
3-Stud mount
A/B Compatible



FLEET MICRO DUAL

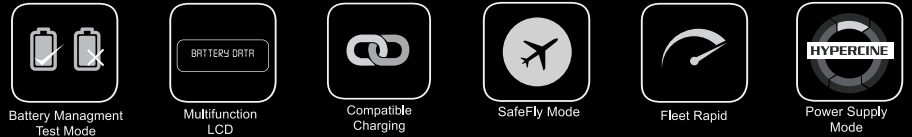

The Fleet Micro series of chargers are the most advanced in the industry. The chargers offer a complete battery management system for your battery “Fleet,” including an on-board LCD to monitor the battery packs’ smart battery data. Besides being the fastest battery charger in the industry today(Two 98wh packs in under 2.5hrs.), the charger offers a TEST mode to determine battery health and recharge performance. With the inclusion of a micro USB on the rear of the unit, that data can then be viewed and managed with a PC application. The micro USB doubles as an input for future free firmware upgrades(downloadable via the web).



FLEET-DM2S
V-mount

Quick Charge Current:
3A Simultaneous

Discharge Current:
Up to 2A per channel

Size: 9.1” x 3.35” x 6.19”

Weight: 3.4lbs

Input Voltage:
90-240VAC 50/60Hz

LCD: 4x20 Character Backlit



FLEET-DM2A
3-Stud mount
A/B Compatible

FLEET RAPID

The Fleet Rapid charger series are simultaneous chargers ideal for ENG, and mobile production. Available in dual and quad models, the super compact design allows it to fit in almost any compartment in a travel bag, while still offering the fastest charge times in the industry. The Fleet chargers have simultaneous yet independent charge bays, allowing each bay to focus on the individual battery connected, completing a recharge on up to four 98wh battery packs in 2.5 hours.

The charger's low profile design takes up as little space as possible, while allowing for stacking. Nearly indestructible, the all-aluminum design will allow the charger to stand up to the demands of production. A recessed carry handle coupled with the slim, light-weight aluminum design, makes it very travel friendly.

FLEET-Q4S

V-mount



Quick Charge Current:
3A Simultaneous

Size: 9.1" x 3.35" x 12.17"

Weight: 5lbs.

Input Voltage:
90-240VAC 50/60Hz

FLEET-Q4A

3-Stud mount



Quick Charge Current:
3A Simultaneous

Size: 8.86" x 3" x 6.19"

Weight: 1.6lbs.

Input Voltage: 90-240VAC 50/60Hz

FLEET-D2S

V-mount



FLEET-D2A

3-Stud mount

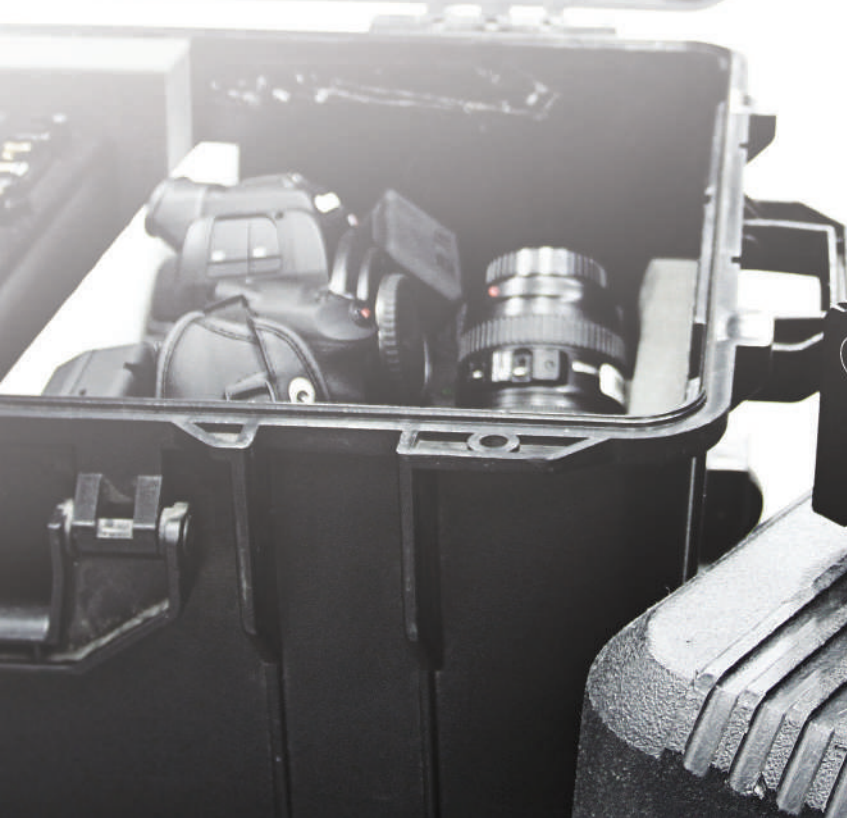

Chargers

X2 mini

Upright Mini
Dual Travel Charger

Input: 100V-240AC 50/60Hz

Charge Current:

1 battery 3.0A, 2 batteries 1.5A

Size: 4.5" x 5.5" x 3"

Weight: 1lb.



GPM-X2S
V-mount



GPM-X2A
3-Stub mount



GP-LS
V-mount
Single Position Charger
& Camera Mounted
Power Supply

BATTERY MOUNT ACCESSORIES

V-MOUNT AND 3-STUD

FX9 —Plate—

Input: 12.5vdc-16.8vdc
(on-board and 4p XLR DC-in).
Inputs are hot swappable.

Output for Camera: DC 19.5v

Output for P-Tap: DC 11.9-17v,
Unregulated



CXA-FX9

GOLD MOUNT PLATE FOR SONY FX9



CXV-FX9

V-MOUNT PLATE FOR SONY FX9

The CXV-FX9 mounts directly to the back of the Sony PXW-FX9, as an alternative power option to the Sony XDCA-FX9



GP-S-CPM

V-MOUNT PLATE WITH CLAMP

The GP-S V-Type plate provides a quick release mechanical and electrical connection with V-Type mount batteries. The GP-S includes a P-Tap port for connection and to power an P-tap cable accessory. The mount plate includes a clamp with max OD of 42mm, to mount to a variety of monopods, tripods, etc.

Input: DC 11-17v

Output for P-Tap: DC 11-17v



GP-A-FS7

GOLD MOUNT PLATE FOR SONY FS7

The GP-A-FS7 3-Stud adapter mounts directly to the back of the Sony FS7. It provides a secure platform for mounting 3-Stud batteries directly onto the FS7 camera.



GP-S-FS7

V-MOUNT PLATE FOR SONY FS7

The GP-S-FS7 V-Mount adapter mounts directly to the back of the Sony FS7. It provides a secure platform for mounting 3-Stud batteries directly onto the FS7 camera.



A-GP-A2PT

GOLD MOUNT PLATE

The A-GP-A2PT is a 3-Stud to 3-Stud adapter, offering 2 additional p-taps for powering accessories.



S-GP-S2PT

V-MOUNT PLATE

The S-GP-S2PT is a v-mount to v-mount adapter, offering 2 additional p-taps for powering accessories.

Input: DC 11-17v **Output for Camera/P-Taps:** DC 11-17v, Unregulated



CORE-SUMOAG

GOLD MNT PLATE FOR ATOMOS SUMO

3 Stud Plate with P-Tap output and 12" 4-Pin XLR Female



CORE-SUMOV

V-MNT PLATE FOR ATOMOS SUMO

V-Mount Plate with P-Tap output and 12" 4-Pin XLR Female



GP-A-C3MK2

GOLD MNT PLATE FOR CANON C3MK2

3-Stud Plate with 2 Powertaps and Lemo compatible with the Canon C300 MKII and Canon C200; 18 inches



GP-S-C3MK2

V-MNT PLATE FOR CANON C3MK2

V-mount Plate with 2 Powertaps and Lemo compatible with the Canon C300 MKII and Canon C200; 18 inches

Input: DC 11-17v **Output for Camera/P-Taps:** DC 11-17v, Unregulated

Powerbase 70

Versatile Battery Pack

77Wh, 4.8Ah

14.8v

6.25" x 1.8" x 3.3"

1.2lbs

The PB70 is part of our Powerbase System. It is a 77wh, 14.8v Lithium Ion Battery pack

The battery pack can be mounted under the camera doubling as a grip or attach to a HD/SLR support via it's 1/4-20 release plate or v-mount.

Wired as a 14.8v pack, it can provide extended power to up to two additional 12vdc devices, as well as other devices requiring lower voltage through an additional XP power regulation cable.

The pack is furnished with a 1/4-20 thread on either side to mount production accessories.



Regulator Block Models

DSLR MODELS:

Canon 5D/7D/60D/T2i/T3/T3i/T4i
Lumix GH3/GH4
SonyA7s

CAMCORDER MODELS:

Canon C300/PB Style
Sony EX/F3/L-series
Panasonic AF100/DV/HPX/HVX
JVC HM600/650

ACCESSORIES



PB70QR
PowerBase Edge
Quick Release Plate



PB70C15US
Powerbase Charger
for North American use only



PB70C15
Powerbase Charger
for Global Use

Wall Sockets



C15-UK



C15-US



C15-AU



C15-EU

BLACK MAGIC CINEMA CAMERA SOLUTIONS

GP-S-BMCC



Size: 3.25" x 5.5" x 0.5"

Plate with double P-Tap outputs and 20" Black Magic Cinema Camera DC pin connection.

Input: DC 11-17v
Output for Camera: DC 11-17v, Unregulated Black Magic Camera Pin
Output for TWO P-Taps: DC 11-17v, Unregulated

Weight: 0.4 lbs.
Compatible with 2.5k and 4k Cinema Cameras

GP-A-BMCC



Size: 3.0" x 4.7" x 0.5"

PB70-BMCC



GP-S-URSA/URSA MINI



Size: 3.25" x 5.5" x 0.5"

Plate with P-tap and BMD 12way Molex connection

Input: DC 11-17v
Output for Camera: DC 11-17v, Unregulated Black Magic Camera Pin
Output for Two P-Taps: DC 11-17v, Unregulated

Weight: 0.4 lbs.

GP-A-URSA/URSA MINI



Size: 3.0" x 4.7" x 0.5"

GP-DV-BMCC



An interchangeable regulator block for the Powerbase-70 to be used with Black Magic Cinema Camera 12" cable.

Input: DC11-17v
Output for Camera: DC 11-17v, 3A
Output for P-Tap:DC 11-17v, unregulated
Green LED Indication: Camera power output

NP Battery Packs



NP-50

Capacity: 50wh (13.2v, 3.8Ah)
 Size: 7.28" x 2.83" x .98"
 Weight: 1.5 lbs.
 Nominal Runtime (25w load): 2hrs.

The NP-50 NiMH offers up to twice the runtime as NiCd NP battery packs. Built in 4-stage LED power gauge. Internal protection circuit monitors temperature and protects against over-charge with a self-resetting cut-off. Compatible with most NP chargers in the field.



NP-L9

Capacity: 65wh (14.8v, 4.4Ah)
 Size: 7.28" x 2.83" x .98"
 Weight: .92 lbs.
 Nominal Runtime (25w load): 2.4hrs.

A lightweight, ultra high capacity NP battery which can be used with existing cameras, monitors, audio equipment, and vtrs, without any necessary modifications.

Requires a Core SWX charger for charging.
 *Please contact us if you intend to use another charger.

Internal protection circuit monitors temperature, and protects against over-charge with a self-resetting cut-off. Built in 4-stage LED power gauge. Integrated P-tap on side of the battery allows you to power any 12vdc device from this port.

NP Chargers

NC-2LJ



Quick Charge Current: 2.0A
 Size: 4.4" x 2.7" x 9.8"
 Weight: 2.0 lbs.
 Input Voltage: 90-240VAC
 50/60Hz

Two position, simultaneous charger, MultiChemistry(NiCd, NiMH, Li-Ion)* and includes a 50w 12vdc camera power supply.

Lightweight and compact, the NC-2LJ can fit inside a small camera bag, making it an ideal field charger for NP batteries.

Trickle charge maintenance program ensures the batteries are always at maximum capacity.

Charges two 50w batteries in 90 minutes.

NC-4LJ



Quick Charge Current: 2.0A
 Size: 8.7" x 2.5" x 9.8"
 Weight: 3.5 lbs.
 Input Voltage: 90-240VAC
 50/60Hz

Four position, simultaneous charger, MultiChemistry (NiCd, NiMH, Li-Ion)* and includes a 50w 12vdc camera power supply.

The NC-4LJ is the optimum charger when having to cycle many NP batteries quickly.

Trickle charge maintenance program ensures the batteries are always at maximum capacity.

Charges four 50w NP batteries in 90 minutes.

SP-2LJ



Quick Charge Current:
 1.0A/2.0A
 Size: 5.3" x 2.5" x 1.3"
 Weight: 0.9 lbs.
 Input Voltage: 90-240VAC
 50/60Hz

An economical solution to full-featured charging, the SP-2LJ charger will safely charge two NP-L60 NP batteries via the P-tap port on the battery in 3 1/2 hours. Its compact design and LED charge indication makes it the perfect solution for a tight budget.

CUBE Power Supplies

CUBE-200



Input Voltage: AC 100-240V 50/60Hz
 DC Output: 200W max(14.3v) via 4pin XLR
 Protection: Over Current, & Temperature
 Dimensions: 4.8" x 3.3" x 3.7"
 Weight: 1.4lbs.

The Core Cube series are lightweight, all aluminum 200w industrial power supplies capable of powering the most power hungry cameras. The power supplies are available in 14V and 24V to support standard and high voltage equipment. The "Cube" is so compact, it fits in the palm of your hand, perfect for "Run and Gun" productions.

Two XLR outputs provide up to 200w combined. The power supply has internal protections to accepts 100-240VAC, making it useable worldwide. Includes an AC power cord.

The Core Cube is fanless, and operates silently.

CUBE-24



Input Voltage: AC 100-240V 50/60Hz
 DC Output: 200W max(24v) via 3pin XLR
 Protection: Over Current, & Temperature
 Dimensions: 4.8" x 3.3" x 3.7"

BOLT300

Material of Light Housing: Anodized Aluminum/Black ABS
Dimensions: 5.23"L × 3.05"W × 1.70"H (Light Body)
Illumination: Approx. 2695LUX(3200K, 1m), 3388LUX(5600K, 1m), combined over 300w output equivalent

Weight: 0.6lbs.
Electrical Consumption: 13w
Power Supply: DC 7.2V-16.8V, Sony DV Battery
Light Adjustment: PWM (pulse width modulation)
Dimming Range: 0%-100%, No Color Shift

Lighting



The TorchLED Bolt 300 leverages a patented Refractory Lens Technology providing a 300W equivalent light output. It draws 13W of power and includes a separate on/off switch.

Featuring a wireless remote, the Bolt 300 can control the light from up to 250 feet away (non LOS). The nine channel remote control and magnetic diffusion filter allows users to control on/off, select color temperature and adjust light intensity. With the remote capability, users can easily adjust light settings at the tip of their fingers. Additionally, the Bolt 300 allows users to bank up to 10 lights per channel, allowing for control of the lights in unison.

The Bolt 300 has an independent knob for color temperature between tungsten (3200K) and daylight (5600K), eliminating the need to mix and match between two dials for the most accurate ambient light. The full 0-100 percent dimming control allows users to change the brightness with no noticeable color shift.

The light also comes with a custom carry case including a 1/4-20 Swivel Shoe mount, PowerTap cable for DC powering off of a standard 14.4V brick battery, a magnetic diffusion filter, battery and charger. In addition to the battery in the case, it accepts Sony L-Series batteries.

#TL-BT300

- INCLUDES:**
 TLBT300 Light
 Powertap Cable
 Magnetic Diffusion Filter
 9 Channel Remote control
 1/4-20 Swivel Hot Shoe Mount
 TLF970 L-Series battery pack(7000mah)
 L-Series Battery charger
 Custom carry case



TORCH LED BOLT PHOTOMETRICS		
DISTANCE	LUX OUTPUT	COLOR TEMPERATURE
2ft/0.6m	10230	4100k mixed
2ft/0.6m	7013	5600k
2ft/0.6m	4637	3200k
3.3ft/1m	5368	4100k mixed
3.3ft/1m	3388	5600k
3.3ft/1m	2695	3200k
6ft/1.8m	1925	4100k mixed
6ft/1.8m	1276	5600k
6ft/1.8m	902	3200k
10ft/3.05m	853	4100k mixed
10ft/3.05m	567	5600k
10ft/3.05m	391	3200k

#TL-BT300K

- INCLUDES:**
 3- TLBT300 Light heads
 3- Powertap Cable
 3- Magnetic Diffusion Filter
 1- 9 Channel Remote control
 3- 1/4-20 Swivel Hot Shoe Mount
 3- TLF970 L-Series battery pack(7000mah)
 1- Dual L-Series Battery charger
 3- Light stands
 1- Carry case



HOTSWAP

Shark Fin Adapters

Input: DC 11-17v
Output for Camera: DC 11-17v, Unregulated Paralleled
Output for 4x P-Tap: DC 11-17v, Unregulated, 7.2A max
Size: 4.6" x 3.5" x 4.7"
Weight: 1.2 lbs

The GP-TA-SFF & GP-TS-SFF are short form factor Hotswap Shark-fin adapter that mounts directly to the existing 3-stud or V-mount plate on the camera. It allows for continuous battery operation, and for additional accessories, it has 2 powertaps.

Since the batteries aren't 'stacked' on one another, you can easily remove the depleted battery while leaving the other battery connected so that there is no down time.



GP-TS-SFF

V-mount



GP-TA-SFF

3-Stud mount

STANDARD HOTSWAPS



GP-TS

The GP-TS Hotswap adapter mounts directly to the existing v-type plate on the camera and allows for continuous battery operation.



GP-TA

The GP-TA Hotswap adapter mounts directly to the existing 3-Stud plate on the camera and allows for continuous battery operation.

ACCESSORIES

HDV-DV CABLES

The XP model DV/HDV cables can be used with CoreSWX accessory or used with only lithium-ion battery product. The cable features a regulated 7.4 battery paddle end for a HDV/DV camcorder with an inline female P-tap connector for 12vdc, housed in an enclosure. Also include both red and green LED indication to display status of battery power.



Input: DC 11-17v
 Output for Camera: DC 7.9v, 3A
 Output for P-tap: DC 11-17v, unregulated
 Green LED indication: power input
 Red LED indication: camera power output
 Length: 20"

XP-DV-P

XP-DV-P20 20" Cable
 XP-DV-P48 48" Cable

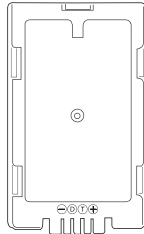

XP-DV-S

XP-DV-S20 20" Cable
 XP-DV-S48 48" Cable

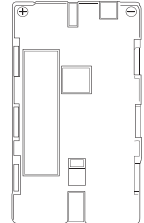

XP-DV-VBG

XP-DV-VBG20 20" Cable
 XP-DV-VBG48 48" Cable

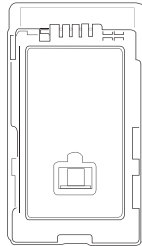

XP-DV-C

XP-DV-C20 20" Cable
 XP-DV-C48 48" Cable

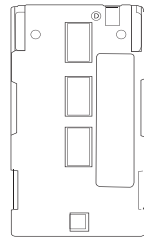

XP-DV-C300

XP-DV-C300/20 20" Cable
 XP-DV-C300/48 48" Cable

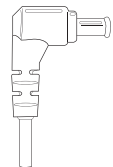

XP-MAGIC-12

The cable features a regulated 2v connector jack to power the Black Magic Mini Converter with an inline female P-Tap connector for 12vdc, housed in an enclosure. Also includes both red and green LED indication to display status of battery power.

Input: DC 11-17v
 Output for Camera: DC12v, 2.5A
 Output for P-Tap: DC 11-17v, Unregulated
 Green LED Indication: Power input
 Red LED Indication: Camera power output
 Length: 24"



XP-AJA-5

XP-AJA-5 cable allows users to plug into any battery via V-mount or Gold Mount plate and power both 12vdc accessories (ie. monitor, light) as well as an AJA mini converter.

Input: DC 11-17v
 Output for Camera: DC 9.2v, 3A
 Output for P-Tap: DC 11-17v, Unregulated
 Green LED Indication: Power input
 Red LED Indication: Camera power output
 Length: 48"



XP-MAR-8

The XP-MAR-8 cable allows users to plug into any battery via V-mount or Gold Mount plate and power both 12vdc accessories (ie. light) as well as the Marshall V-LCD50-HDMI.

Input: DC 11-17v
 Output for Camera: DC 9.2v, 3A
 Output for P-Tap: DC 11-17v, Unregulated
 Green LED Indication: Power input
 Red LED Indication: Camera power output
 Length: 48"

ACCESSORIES

CABLES



XP-ZOOM-5

Converts PowerTap Male to 4-pin XLR Female 28"



PT-XLR

Converts PowerTap Male to 4-pin XLR Female 28"



PTM-PTF-CABLE

PowerTap Male to Female Cable 36"



PT-CABLE

Open Terminal PowerTap Cable 28"



PT-XF3

Converts PowerTap Male to Female PowerTap and 4-pin XLR Female 8"



PT-FS12 & FS24

P-Tap Cable to Power Blackmagic 2,5k and 4k cameras as well as Firestore HardDrive 12" or 24" Converts Power Tap Output to a Firestore Pin Connection



PT-C3MK2

Input: DC 11-28v
Output: DC 9.2V, 2A

PowerTap Cable to Lemo C300 MK2; 24"



XP-EX-S20 & S48

The XP-EX-S cable allows you to power both Sony EX/Sony PXW-FS7 camcorder and a 12v accessory (i.e. monitor, on-camera light) from any powerTap 12v power



PTC-NPF

Coiled PowerTap Cable to Sony NPF L Series battery block, pTap regulated 18" extends to 48" for Sony Camcorders and Atomos



PTC-GH4DUO

Coiled PowerTap Cable to Panasonic GH4 battery block and 4-pin XLR for YAGH Module, pTap regulated 18" extends to 48"



PTC-BMPC4

Coiled pTap cable to 2pin connector for BMD Pocket 4K; 18" extends to 48"



PTC-TVL-04

PowerTap(Ptap) to TvLogic mini-XLR, 18" extends to 48"



PTC-LPE6

Coiled PowerTap Cable to Canon LPE6 battery block for Canon DSLRs, SmallHD Monitors, etc. P-tap regulated 18" extends to 48"



PTC-BMCC

Coiled PowerTap Cable to Black Magic Cinema Camera 2.5K/4K, pTap unregulated 18" extends to 48"



PTC-A7S

Coiled PowerTap Cable to Sony A7s battery block, p-tap regulated 18" extends to 48"



LC-TVL-02

2pin Lemo(Arri) to TvLogic mini-XLR, 18" extends to 48"



LC-TVL-04

4pin Lemo(RED) to TvLogic mini-XLR, 18" extends to 48"



PTC-CGA

Coiled PowerTap Cable to Panasonic CGA-D54 battery block, pTap regulated 18" extends to 48"



PTC-XLR

Coiled PowerTap Cable to 4-Pin XLR Female, pTap unregulated 18" extends to 48"



PTC-GH4

Coiled PowerTap Cable to Panasonic GH4 battery block, pTap regulated 18" extends to 48"



PTC-CSZ

Coiled PowerTap Cable to Canon Servo Zoom 18" extends to 48"



129 mm 124 mm 59.94P 06:26:28.01F
18
5130K -0 T2.8 1/800 90.00 211

NANUK
M-SERIES
5v CHECK 14.8v
#NANO-C88 SMARTAP

FF 0231

BALANCE





91 Commercial St.
Plainview, NY 11803
Tel: (888) 283-9995 (516) 595-7488
Fax: 516-595-7492
Email: sales@coreswx.com

Design and specifications are subject to change without notice. Product and company names mentioned here are trademarks and registered trademarks of their respective owners. All content 2021 CoreSWX LLC. No reproduction without permission.