

A-DCFX9

V-Mount Battery Adaptor for Sony PXW-FX9



Instruction Manual

Thank you for purchasing the A-DCFX9. A-DCFX9 is an IDX Imicro battery adaptor for Sony PXW-FX9. Prior to using the product, please read this manual carefully and understand the basic handling methods and precautions before using the product safely. After reading it, be sure to keep it in a place where you can see it at any time.

⚠ WARNING

May cause sudden serious injury and death

- Do not use the product beyond the rated or operating conditions of the device.
- Do not carry or store with metal equipment.
- Do not immerse in water.
- Do not attempt to open the outer casing or break apart.
- Do not subject the unit to extreme physical impact or pressure.
- Do not short the contact pins with any metal object.
- Do not attempt to use if damaged.
- Do not place heavy objects or apply pressure.
- Do not damage the cable.
- When connecting the cable, do not pull the cable strongly.

⚠ CAUTION

May cause sudden serious injury and death

- The unit should be used under the conditions listed in this manual.
- Do not expose the unit to extremely high temperatures.
- Keep the unit away from fluid or high humidity environment.
- Remove it from the device and stop using it immediately if an odour, leakage, discoloration or deformation is noticed. Do not carry the adaptor while the battery is attached.
- Remove the battery after use.
- Check the input voltage of the device to be used before connecting.

Features

- Converting to 19.5V output from IDX Imicro battery to operate Sony PXW-FX9.
- Compact, light weight, durable construction
- Equipped with Alarm LED

Parts Description

- | | | |
|-----------------|---------------------|--------------------------|
| ① Body | ④ Battery connector | ⑦ Camera mounting screws |
| ② Release lever | ⑤ D-Tap | ⑧ Alarm LED |
| ③ V-mount | ⑥ Out put plug | ⑨ Guide |

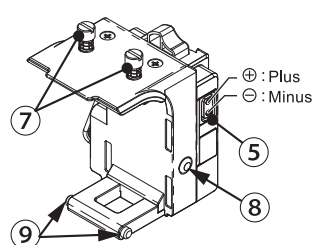
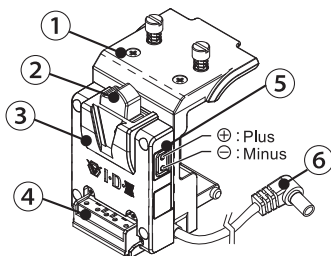

Specifications

- Recommended batteries : IDX V-mount Imicro battery
 - Output plug : 19.5V
 - D-Tap output : DC Unregulated MAX 80W
 - Output plug : outside diameter : approx. 6.5mm / 0.25 inches
inside diameter : approx. 4.3mm / 0.17 inches
Pin diameter : approx. 1.4mm / 0.05 inches L-shaped
- Minus  Plus
- Alarm LED : Light RED when the battery capacity becomes low.
 - Discharging temperature : -20°C ~ 45°C / -4 ~ 113°F
(recommended 10 ~ 40°C/50 ~ 104°F)
 - Dimensions : approx. 66 (W) × 101.5 (H) × 84 (D) mm
approx. 2.59 (W) × 3.99 (H) × 3.3 (D) inches
*Warning. Do not use these dimensions for reference.
 - Weight : approx. 400g / 0.88 lbs

Attaching the A-DCFX9 to the PXW-FX9

- | | |
|--|---|
| ① : Remove screws and the cover from the camcorder. | ③ : Fit the upper part of the A-DCFX9 into the guide hole of the camcorder. |
| ② : Connect the output plug to DC IN connector of the camcorder. | ④ : Tighten the mounting screws to fix. |

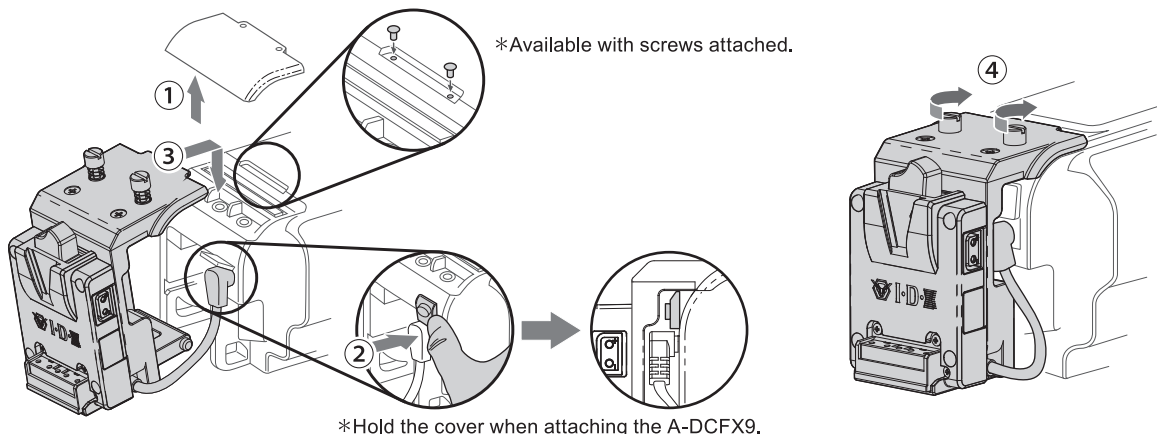

Design and specifications are subject to change without notice.